

Pre-Operations Report

Operation Name: Homesteader
Management Basin: Buster
County (%): Clatsop 100%

Sale Quarter: 3rd
BOF %100
CSL %

I. VOLUME AND VALUE SUMMARY

Table 1. Types, Acres, and Value

Area	Harvest Type	Anticipated Product ³	Gross Acres	Net Acres	MBF/Acre ¹	MBF/Area ¹	\$/MBF ²	\$/Area
1	PC-M	DF-S	58	48	7	336	\$350	\$117,600
2	MC	RA/DF-M	59	51	35	1,785	\$350	\$624,750
3	MC	DF-M	106	95	50	4,750	\$350	\$1,662,500
4	MC	DF-M	28	24	50	1,200	\$350	\$420,000
5	MC	DF-M	40	37	50	1,850	\$350	\$647,500
6	R/W ⁴	DF-M	4	4	50	200	\$350	\$70,000
Total		Regeneration	237	211		10,121		
		Partial Cut	58	48				
						Gross Value		\$3,542,350
						Project Costs		\$435,550
						Net Value		\$3,106,800

- Estimated harvest volume per acre or Area.
- Estimated 'stumpage value' (excluding Project Costs)
- Anticipated Product (AA-B-C) – AA) SLI species code of the bid species, B) Size Class (S – small [average DBH < 15], M – medium [average DBH 15 to 23], L – large (average DBH > 23)), C) Special Product (P – Premium, H – Hardwood)
- This is new road construction right-of-way (R/W) acres that will be removed to facilitate the new road(s). The acres are counted as regeneration acres because all the trees are removed within the right-of-way area.

II. PHYSICAL DESCRIPTION OF OPERATION AREA

Table 2. Physical Characteristics of Operation Area

Location: T5N, R7W, Sec. 13 & 24 (Spur off Grand Rapids); T5N, R6W, Sec. 7, 17, 18, & 19 (Wage Road)	
Rainfall: 60-80 Inches	Elevation: 480' to 920'
Site Index: 140	Aspect: North
Vegetation Zone: Hemlock	Other:
Soils: Rinearson Silt Loam (Portions of Areas 1-5), Mayger Silt Loam (Portions of Areas 6 and 7), Hemcross Silt Loam (Portions of Area 3)	

III. CURRENT STAND CONDITION:

Table 3. Stand Inventory Information

Area	Stand ID	Measured /Imputed ¹	Species	Age	TPA	DBH	BA	% SDI	Net Acres
1	24001	M	DF	38	188	16	268	68	43
	23989	M	DF,CX	27	378	11	267	77	5
2	23995	I	RA, DF	64	145	17	230	57	44
	24003	I	DF, WH	114	176	20	364	85	7
3	23996	I	DF/RA	81	117	20	266	61	95
4	23985	I	DF	74	160	18	291	70	24
5	23971	M	DF	114	117	20	266	61	37

- Identify the source of stand inventory information. Use the following codes: M = Measure SLI data, I = Imputed SLI data, P = Pre-Cruise Plots, O = other (if other, describe below).

Table 4. Additional Stand Information

Area	Stand ID	Snags/ Acre ¹	Down Wood / Acre ²	% Ground Cover	Predominant Understory Vegetation	Forest Health Issues
1	24001	0	42.81	48.42	Swordfern, Vinemaple, Salmonberry	None Known
1	23989	0	0	69.92	Vinemaple, Salmonberry	None Known
2	23995 (75%)	1.25	350.44	92.35	Salmonberry, Vinemaple, Swordfern	None Known
2	24003 (25%)	9.02	2433.96	75.42	Salmonberry, Vinemaple, Swordfern	None Known
3	23996	5.51	373.45	85.82	Swordfern, Vinemaple, Or. Oxalis	None Known
4	23985	4.96	156.30	62.31	Swordfern, Vinemaple, Huckleberry	None Known
5	23971	5.51	373.45	85.82	Swordfern, Vinemaple, Or. Oxalis	None Known

1. Identify the number of hard snags per acre (decay classes 1 and 2).
2. Identify the cubic feet per acre of hard down wood (decay classes 1 and 2)

IV. DESIRED FUTURE CONDITION/VISION:

Table 5. Stand Structure Information

Area	Stand ID	Current	Post Harvest ¹	Desired Future	Net Acres
1	24001	UDS	UDS	GEN	43
1	23989	UDS	UDS	GEN	5
2	23995	UDS	REG	GEN	44
2	24003	LYR	REG	GEN	7
3	23996	LYR	REG	GEN	95
4	23985	LYR	REG	GEN	24
5	23971	LYR	REG	GEN	37

1. The stand is expected to develop into this condition in the five to ten years after this operation is completed.

Area 1 is a planned first entry thinning that will remove intermediate trees, releasing the overstory and maintaining maximum tree growth. All minor species will be reserved to create more stand variability. Ten to 15 years from this entry the stand will be evaluated for either a second thinning or regeneration harvest.

Areas 2, 3, 4, and 5 are not planned to have a complex desired future condition on the landscape. Five to seven conifer trees per acre will be left to provide a source for natural regeneration, future downed wood, snags, and other wildlife needs. A precommercial thinning is anticipated at 12-17 years when crowns close followed by a commercial thinning at 30-40 years of age to ensure continued growth. At age 50-60 the stands will be evaluated for either additional thinning or regeneration harvest.

V. PROPOSED MANAGEMENT PRESCRIPTION:

Table 6. Prescription

Area	Harvest Type	Harvest Species	Residual Species	Residual TPA	Residual BA	Residual SDI
1	PC-M	DF/WH	DF,H, A, C	80-90	100-120	25-30
2	MC	RA/DF/WH	CX	5-7	NA	NA
3	MC	DF/RA	CX	5-7	NA	NA
4	MC	DF	CX	5-7	NA	NA
5	MC	DF	CX	5-7	NA	NA

Table 7. Structural Components

Area	Purpose	Species	DBH	TPA	Arrangement					Anticipated Down Wood (ft ³ /Acre)
					Scattered in Unit	Clumps in Unit	In Unit RMA	Adjacent RMA	Green Tree Area	
2	GTR	CX	N/A	5-7	X		X			600
3	GTR	CX	N/A	5-7	X		X			600
4	GTR	CX	N/A	5-7	X					600
5	GTR	CX	N/A	5-7	X					600

Table 8. Pathway

Area	Reforestation			Pre-commercial Thinning		Partial Cut A	Partial Cut B	Regeneration Harvest
	Type	Species	TPA	Age	TPA	Age	Age	Age
2	Initial	DF/CX	250-300	17	150	35	50	70
3	Initial	DF/CX	250-300	17	150	35	50	70
4	Initial	DF/CX	250-300	17	150	35	50	70
5	Initial	DF/CX	250-300	17	150	35	50	70

Table 9. Site Preparation

Area	Site Prep				Other issues (Big Game, Mtn. Beavers, SNC, etc)			
	Slash Treatment	Whole Tree Yarding	Chemical	Other	Vegetation	Animal	Insect & Disease	Other
2	Piling & Burning	X	X			Mtn. Beaver		
3	Piling & Burning	X	X			Mtn. Beaver		
4	Piling & Burning	X	X			Mtn. Beaver		
5	Piling & Burning	X	X			Mtn. Beaver		

VI. HARVESTING AND ACCESS CONSIDERATIONS:

Table 10. Harvest System and Access Summary

Area	Harvest System		Slope (%)	Area Access	Seasonal Access
	% Cable	% Ground			
1	0%	100%	<35%	Simple	All Weather
2	0%	100%	<35%	Simple	All Weather
3	25%	75%	35-65%	Established	All Weather
4	0%	100%	<35%	Established	All Weather
5	0%	100%	<35%	Simple	All Weather

Are Easements required along haul route? YES NO

If "yes", describe below easements that need to be obtained.

Are property line surveys required for this operation? YES NO

If “yes”, describe the lines to be surveyed, type of survey (i.e. section subdivision, refresh previously established line, etc.), and length of survey.

The western boundary of Area 7 lies along the property line with a small private landowner. This line needs to be re-witnessed.

Are Invasive Species present along the haul route? YES NO

If “yes”, describe below the management actions necessary to meet management goals for these species.

Table 11. Transportation Management Summary (Miles or Number of Crossings)

Activity	Mainline	Collector	Rocked Spur	Dirt Spur
Construct			0.4	0.5
Improve		3.2	4.7	
Maintain		4.2	5.3	
Block (Dormant)				0.5
Vacate				
Stream Crossings				
Type F				
Type N				

Grand Rapids Road and sale access spurs will be evaluated for road improvement and needs. A fifteen mile brushing project has been added to the project portion of this sale. This will brush the roads to be improved and other roads in the Grand Rapids area. Approximately 7,000 cubic yards of 4”-0” crushed rock will be produced at Buster and approximately 7,500 cubic yards of 1½”-0” crushed rock will be produced at Nettle.

VII. AQUATIC RESOURCES AND WATER QUALITY:

Table 12. Stream Classifications Within or Adjacent to the Operation

Area	Fish Bearing (Type F)	Operating in Inner Zone of Type F	Non-Fish Bearing (Type N)				Unknown - Fish Presence Surveys Required
			Large / Medium	Small Perennial	H.E.R. / P.D.F.T	Other	
1							Yes
2	X						Yes
3							Yes
4							Yes
5				X			Yes

Table 13. Additional Stream Considerations

Area	AA Basin	Potential Stream Habitat Project	Domestic Water Sources Present	Stream Name
1	None	None	None	Nehalem River
2	None	None	None	Nehalem River
3	None	None	None	Nehalem River
4	None	None	None	Nehalem River
5	None	None	None	Nehalem River

Opportunities exist for stream enhancement in Area 3. If stream enhancement was to occur in this Area it would most likely be cable placement.

VIII. WILDLIFE AND T&E SPECIES CONSIDERATIONS:

Table 14. Northern Spotted Owls - Surveys and Presence

Area	NSO Surveys Required ¹	Years Surveys Completed	Additional Surveys Planned	NSO Response
1	Yes	2012, 2013 & 2014	2015	No
2	Yes	2012, 2013 & 2014	2015	No
3	Yes	2012, 2013 & 2014	2015	No
4	Yes	2012, 2013 & 2014	2015	No
5	Yes	2012, 2013 & 2014	2015	No

1. Surveys are required if the Area contains NSO habitat, as determined by Area Wildlife Biologist. Enter “Yes” or one of the following codes when surveys are not required: “N.H.” – no habitat within the Area; “N.R.” – surveys of individual operations are not required (Klamath-Lake District only); “T.B.” – surveys are not required because the Area is within the Tillamook Burn (see NSO Policy); “HCP” – covered by a Habitat Conservation Plan; “S.W.” – a survey waiver has been issue for another reason (explain below or attach the waiver).

Is the Operation within an NSO Provincial Circle or Home Range? YES NO

If “yes”, attached the preliminary Biological Assessment.

Table 15. Marbled Murrelets - Surveys and Presence

Area	MM Surveys Are Required ¹	Years Surveys Completed	Additional Surveys Planned	MM Observations
1	S.S.	N/A	N/A	N/A
2	S.S.	N/A	N/A	N/A
3	S.S.	N/A	N/A	N/A
4	S.S.	N/A	N/A	N/A
5	S.S.	N/A	N/A	N/A

1. Survey are required if the Area contains or is adjacent (within 330 feet) of potential marbled murrelet habitat, as determined by Area Wildlife Biologist. Enter “Yes”, or one of the following codes when surveys are not required: “N.H.” – no potential habitat within or adjacent to the Area; “O.Z.” – outside the Marbled Murrelet Survey Zone; “S.S.” – in Systematic Survey Zone; “T.C.” – tree climbing was used (or planned) instead of the normal survey protocol; “HCP” – covered by a Habitat Conservation Plan; “S.W.” – a survey waiver has been issue for another reason (explain below or attach the waiver).

Is the Operation within a Marble Murrelet Management Area? YES NO

If “yes”, attached the preliminary Biological Assessment.

Other Wildlife Considerations:

T&E Fish:

This sale is within the Coastal Coho ESU. These fish are federally listed as “threatened”. Streams with fish presence adjacent or within the sale areas may contain Coastal Coho.

T&E Plants:

Does the Oregon Natural Heritage Program database or field reconnaissance indicate the presence of known threatened or endangered plants near the operation? YES NO

IX. SLOPE STABILITY AND GEOTECHNICAL ISSUES:

Table 16. Summary of Slope Stability Assessment¹

Area	Potential Hazards ²					Geotech Review to Date	Additional Geotech Review
	Deep Seated Landslide	HLHL – Risk to Stream	HLHL – Risk to Public	Debris Flow Stream (FPA/FMP)	Inner Gorge		
1	Ancient	N	N	N	P	Office	None
2	Ancient	N	N	N	P	Office	None
3	Ancient	N	N	N	N	Office	None
4	Ancient	N	N	N	L	Office	None
5	Ancient	N	N	N	N	Office	None

¹ All assessments are based on the review conducted to date; additional field work by the Geotechnical Specialist (Geotech), foresters, or others may identify additional sites or risks that could lead to further evaluation or modification of the operation. Additionally, most or all of the above potential issues may be mitigated during timber sale layout by boundary changes, buffering, green-tree retention areas or other modifications prior to harvest.

² The potential hazards are rated as: N – Not Present; NL - Not Likely, additional action is not required; L – Likely, additional field review by forester or Geotech required; P – Present, specific hazards have been identified. Additional detail on “deep seated” is provided as observed.

X. RECREATION RESOURCES:

Table 17. Recreation Sites In the Vicinity of the Operation¹

Type of Recreation Site or Facility	In or Immediately Adjacent to the Operation	In the Vicinity of the Operation (1/4 mile)	On the Anticipated Haul Route
Motorized Trails	No	No	No
Non-Motorized Trails	No	No	No
Campgrounds	No	No	No
Other Recreation Sites or Facilities	No	No	No

XI. CULTURAL RESOURCES:

Does the ODF Cultural Resources Inventory or field reconnaissance indicate the presence of cultural resources in and adjacent to this operation? YES NO

XII. SCENIC RESOURCES:

The district has reviewed the scenic potential of vantage points in and around this operation. This review shows that this operation contain Areas with an ODF Visual Classification of 2.

Area 2 is visual from HWY 103. Green Tree Retention will be focused on the North Slope Facing HWY 103.

XIII. OTHER RESOURCE CONSIDERATIONS:

Are there other resources present in or around this operation that need special consideration?

YES NO

All sale areas are within the 8-01 taxing district.

Homesteader FY2016

Portions of Section 13 & 24 T5N, R7W, and
Portions of Sections 7, 17, 18, & 19 T5N, R6W, W.M.,
Clatsop County, Oregon.

Area 1 (PC) = 48 Acres	Area 4 (MC) = 24 Acres
Area 2 (MC) = 51 Acres	Area 5 (MC) = 37 Acres
Area 3 (MC) = 95 Acres	Area 6 (R/W) = 4 Acres

Total MC Acres = 211
Total PC Acres = 48

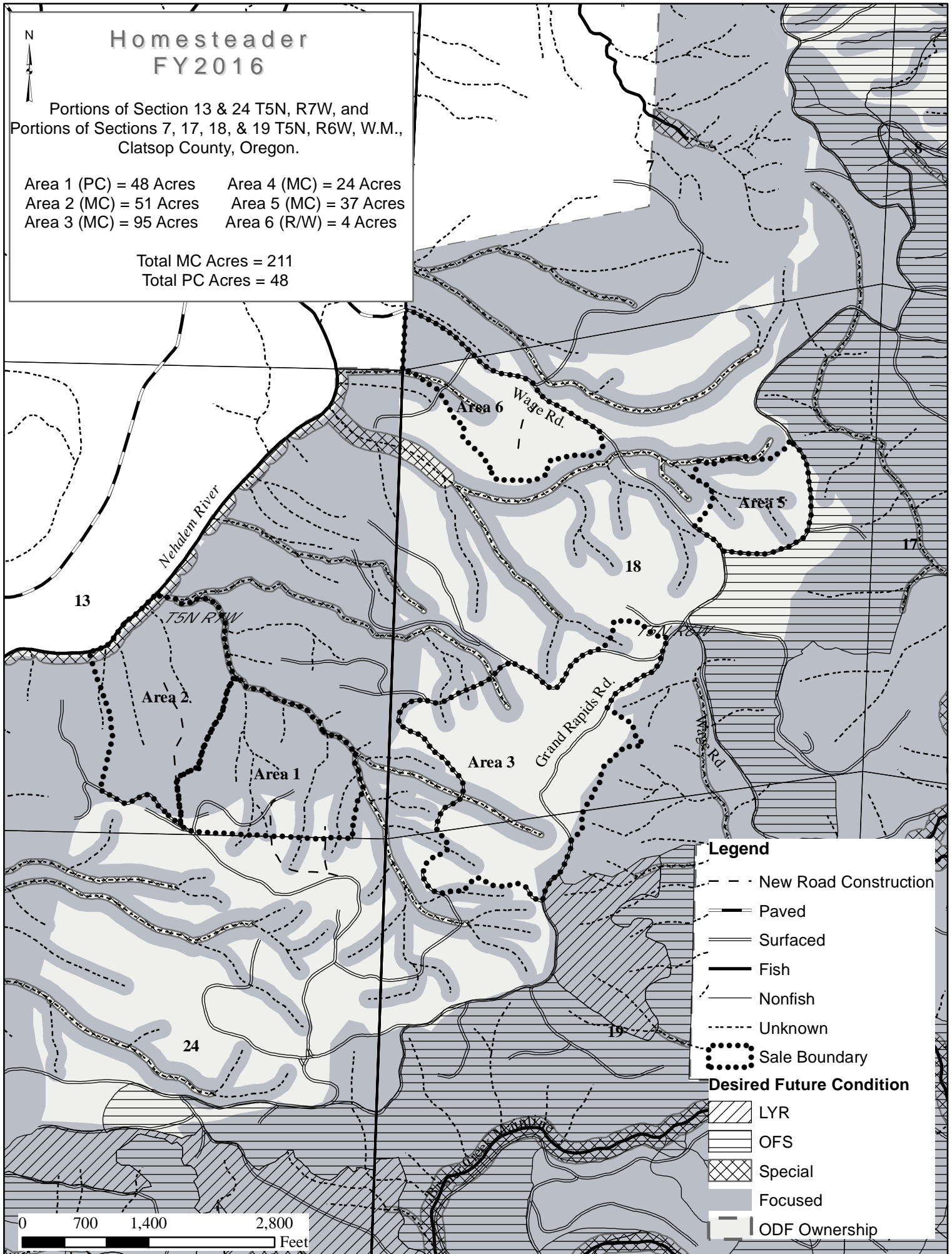

0 700 1,400 2,800
Feet